



welcome TO

Sheraton Seoul D Cube City Hotel - Located in the heart of the D-Cube City development, near direct subway access and multiple dining, shopping, and entertainment venues.

Rooms

Enjoy our 269 well-appointed guest rooms and 12 spacious suites. Network all hours of the day at the large work desk, outfitted with an ergonomic chair and High Speed Internet Access. Or simply sit back and relax thanks to the 42-inch full HDTV and refreshment center. State-of-the-art details, like electronic drapes, bedside lighting control and an international power outlet, make everything easy. Unwind in the soothing bathroom with Shine for Sheraton™ bath amenities, bathrobes and slippers before settling into the signature Sheraton Sweet Sleeper™ Bed topped with a plush mattress and downy duvet.

Overview

We look forward to welcoming you to Sheraton Seoul D Cube City Hotel offering everything you need for a relaxing and connected stay. Just 15 kilometers from Gimpo Airport (GMP) and 55 kilometers from Incheon International Airport (ICN), our hotel is the perfect choice for both business and leisure and travelers.

Features

Organize your day with the help of our expert Concierge Team, who is happy to assist with local area information, reservations, recommendations and more. Meanwhile, the Business Center and Link@Sheraton experienced with Microsoft will take care of all on- and off-site connections. Relax after a busy day of meetings or sightseeing with a workout at Sheraton Fitness, complete with indoor swimming pool, sauna, gym and golf range, or unwind at Aequalis Spa. Then, gather at the end of the day in the Sheraton Club Lounge to share you stories.

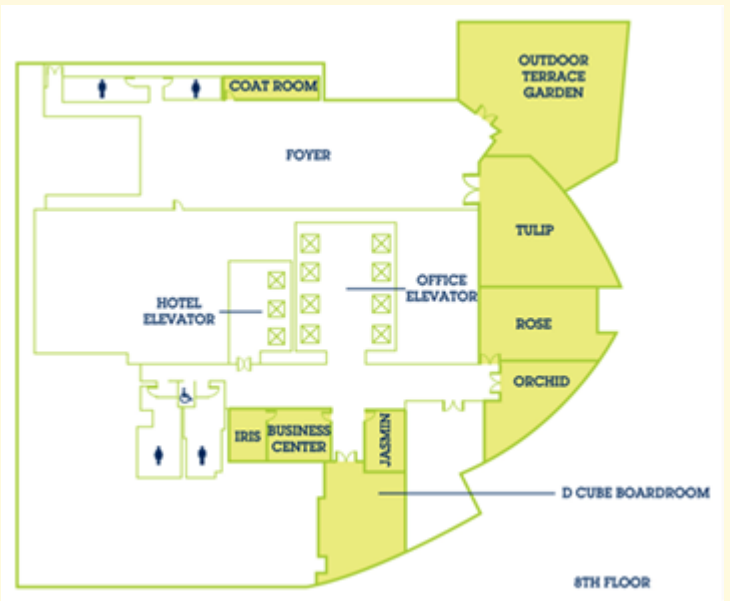
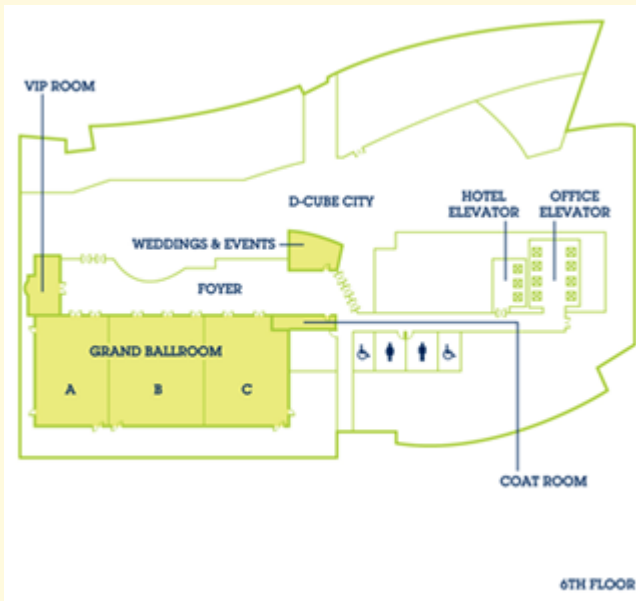

MEETING CAPACITY CHART

Room Name	Key	Dim. (l x w)	Area	Height	Banq.	Thtr.	Conf.	Rec.	Class	U-Shp	H.Sq.	Dinner	Dance
First Floor													
Grand Ballroom	-	147.6' x 65.6'	9688sq ft	19.7'	510	933	-	933	500	180	-	-	
Ballroom 1	-	39.4' x 62.3'	2756sq ft	19.7'	150	150	-	259	140	60	-	-	
Ballroom 2	-	52.5' x 62.3'	3520sq ft	19.7'	180	347	-	158	185	60	-	-	
Ballroom 3	-	52.5' x 62.3'	3412sq ft	19.7'	180	327	-	175	175	60	-	-	
Lavender Room	-	26.2' x 52.5'	1550sq ft	9.8'	80	140	-	110	75	30	-	-	
Lily Room	-	29.5' x 29.5'	958sq ft	9.8'	40	84	-	40	45	24	-	-	
Calla Room	-	36.1' x 29.5'	1109sq ft	9.8'	50	104	-	70	55	46	-	-	
Gardenia Room	-	52.5' x 29.5'	1690sq ft	9.8'	60	153	-	90	82	28	-	-	
Tulip Room	-	32.8' x 39.4'	1195sq ft	9.8'	60	112	-	60	60	47	-	-	
Rose Room	-	29.5' x 23.0'	807sq ft	9.8'	40	73	-	40	39	22	-	-	
Orchid Room	-	-	495sq ft	9.8'	-	-	-	-	-	6	-	-	
Jasmin Room	-	-	226sq ft	9.8'	-	-	-	-	-	8	-	-	
Iris Room	-	-	172sq ft	9.8'	-	-	-	-	-	6	-	-	
D Cube Board Room	-	-	797sq ft	9.8'	-	-	-	-	-	16	-	-	